

5,280 feet = 1 mile

5,280 feet = 1 mile

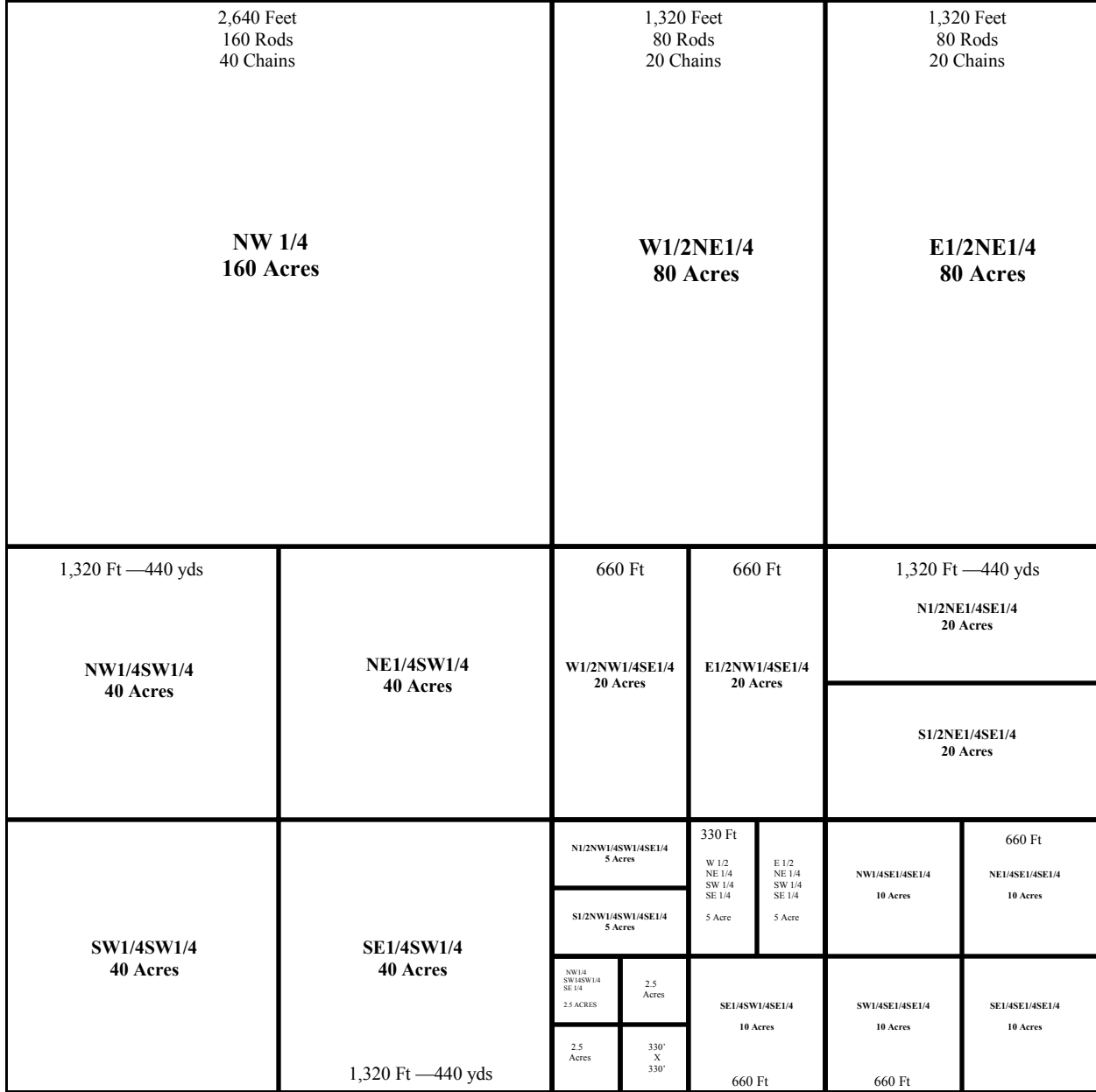

LAND MEASUREMENTS

- 1 Link = 7.9 inches
- 1 rod = 16.5 feet
- 1 chain = 100 links = 60 feet
- 1 furlong = 40 rods = 660 feet
- 1 mile = 8 furlongs = 80 chains = 320 rods = 5,280 feet
- 1 sq rod = 272.25 sq feet
- 1 acre = 160 square rods = 4,840 square yards = 54,560 square feet