

GOSHEN COUNTY PUBLIC WORKS CONSTRUCTION PERMIT

(THIS PERMIT IS REQUIRED FOR ANY NEW CONSTRUCTION AND/OR MAINTENANCE OPERATION PERFORMED BY OTHERS WITHIN GOSHEN COUNTY RIGHT-OF-WAY. SPECIAL MAINTENANCE OR EMERGENCY OPERATIONS PERMITS MAY ALSO BE ISSUED)

Permittee: _____

Date: _____

Permitter: Goshen County

Permit No.: _____

APPLICANT INFORMATION

Project Location: (Road Number/Section/Quadrant-Lot/Block/Subdivision) and/or **Local Project Name:** _____

Owner:	Mailing Address	Zip Code	Phone
--------	-----------------	----------	-------

Contractor:	Mailing Address	Zip Code	Phone
-------------	-----------------	----------	-------

Project Engineer: (If Applicable)	Mailing Address	Zip Code	Phone
-----------------------------------	-----------------	----------	-------

Estimated Start Date: _____ **Estimated Completion Date:** _____

Brief Description of Proposed Construction Work: (Purpose of Project/Type of Work) _____

Description of Materials: (Brief Description of Key/Basic Construction Materials) _____

Traffic Control Plan: (Can Only be Waived by County Road Superintendent; **SEE ATTACHED GOSHEN COUNTY MINIMUM STANDARD DETAIL**) _____

Waiver of Traffic Control Plan
County Road & Bridge Superintendent: _____

Contact Person (24 Hours)	Phone Number (24 Hours)
---------------------------	-------------------------

PERMIT REQUIREMENTS

1. A plan or drawing shall be submitted with the permit showing the approximate location of the project, details of the construction project and types/specifications/sizes of materials to be used on the project.
2. Every construction/maintenance site requested by this permit shall be visited and inspected by a representative of Goshen County with the owner or applicant also present to determine construction/maintenance location requirements.
3. All Facilities proposed to be located underground within the County Right-of-Way, shall be placed a minimum of three feet (3') below the lowest point in the Right-of-Way. Special site conditions may result in greater depth requirements.
4. All Construction shall comply with the Wyoming Public Works Standard Specifications (2001 Update) and /or any applicable Goshen County Supplements. Encasement of utilities installations may be required.
5. A permit will not be issued without proof of "Utilities Locate Request" provided by the Wyoming One-Call, to be attached to the permit. (1-800-849-2476) All work shall be performed in compliance with the "Wyoming Underground Facilities Notification Act". (WY Statutes 37-12-301 through 37-12-305).
6. As constructed drawings (3-Dimensional record of locations complying with the above referenced "Wyoming Underground Facilities Notification Act") shall be submitted to and approved by the County Surveyor at completion of the project.
7. A Traffic Control Plan is required any time any portion of Public Right-of-Way is closed for one hour or more. (See County Road Superintendent Approval above. Also see attached Goshen County Minimum Standard Detail.) The contractor/owner understands that the County reserves the right to place traffic control devices in the Public Right-of-Way at the contractor's/owner's expense if the traffic control does not meet "Manual on Uniform Traffic Control Devices Standards".
8. This permit becomes null and void if construction or maintenance work authorized is not commenced within 90 days, or if construction or maintenance work is suspended or abandoned for a period of 30 days at any time after work commenced.

(CONDITIONS, FEES, APPROVALS/SIGNATURES – NEXT PAGE)

CONDITIONS OF PERMIT

1. Such work of construction or maintenance shall be done in such a manner as to in no way interfere with the use, operation and maintenance by the County, for a County Road, and for County Road purposes, or to endanger the general public in its use of said County Road Right-of-Way.
2. The said Permittee shall give to the Goshen County Road and Bridge Superintendent at least five (5) days written notice before entering upon the County Road Right-of-Way for the purpose of the construction and/or maintenance activity.
3. **Special Maintenance or Emergency Operations:** In case of Emergency maintenance, Utility owner will contact the Goshen County Road Superintendent or leave a "voice mail" message at said Road Superintendent's phone (307-532-3716). Following the event a written report of the repairs or maintenance/construction will be submitted to the County Road Superintendent and if the project is determined to need a permit, the "Normal Permitting Process" will then be followed.

 "Special Maintenance" Permits may be granted to Utilities for redundant maintenance operations which are unique to the individual Utilities needs. These "Special Maintenance" permit applications will be evaluated on an individual basis and the terms, conditions, duration and the cost of the permit will be determined jointly by the County Road Superintendent, the Utility and the County Surveyor/Engineer.
4. The said Permittee hereby assumes all liability for, and agrees to pay for all loss of, or damages to property, and injury to or death of persons, including all cost and expenses incident thereto, arising, wholly or in part, from or in connection with the existence of, construction, alteration, maintenance, repair renewal, reconstruction, operation, use or removal of the said facility or any defect therein, or failure thereof, causing same or contributing in any manner to the loss of or damage to such property, or the injury to or death of any person. The said Permittee shall forever indemnify the County, and the Board of County Commissioners, or either of them, against and save them harmless from all liability for any such loss, damage, injury or death, including the costs and expenses incident thereto.
5. The County reserves the right to use, occupy, and enjoy its Right-of-Way for a County Road and for County Road purposes, in such manner and at such times as it shall desire, the same as if this instrument had not been executed by it. If any such use shall at any time, necessitate any change in the location or manner of use of said facility, or any part thereof, such change or alteration shall be made by the Permittee, at the sole expense of the said Permittee, upon the demand of the Board of County Commissioners, and the said County shall not be liable to the Permittee on account thereof, or on account of any damage growing out of any use which the County may make of said Right-of-Way.
6. The County and the Board of County Commissioners hereby disclaim any representation or implication that it retains any title in any County Road Right-of-Way, other than a perpetual easement for the use thereof, and the Permittee, by signing this contract, accepts notice and agrees that any expenses or damages incurred by the Permittee, abandonment, removal, reconstruction or alteration of any County Road by the County shall not vest any cause of action in, nor give any right to recovery therefor to the said Permittee through the abandonment, removal, reconstruction or alteration of any County Road, and any and all expenses or damages incurred by said Permittee through the abandonment, removal, reconstruction or alteration of any County Road, shall be borne by the Permittee.

I hereby certify that I have read and examined this Application/Permit and know the same to be true and correct. All provisions of laws and ordinances governing this type of work will be complied with whether specified herein or not. The granting of a permit does not presume to give authority to violate or cancel the provisions of any other State or Local law regulating construction or the performance of construction.

Permittee (Owner or Representative)	Date	Project Engineer (if applicable)	Date
-------------------------------------	------	----------------------------------	------

GOSHEN COUNTY INFORMATION

Inspection Fees	\$ 50.00	Marker Fees (Each)	\$ 25.00
Plan Review Fees	\$ 50.00	x Number Needed	_____
<u>Closure and Filing Fees</u>	<u>\$ 25.00</u>	+ Base Permit Fee	\$125.00
Base Permit Fee	\$125.00	= Total Fees Due	_____

TOTAL FEES DUE _____ **FEES ARE NONREFUNDABLE**

Please make check payable to Goshen County.

Fees Paid By: _____ Date: _____
 Check No: _____

Special Conditions - County: _____

Approved by:

 County Road & Bridge Superintendent Date

 County Surveyor or Engineer Date

ROAD SIGN REQUIREMENTS FOR UTILITY WORK OR CONSTRUCTION BY PRIVATE CONTRACTORS IN GOSHEN COUNTY RIGHT-OF-WAY

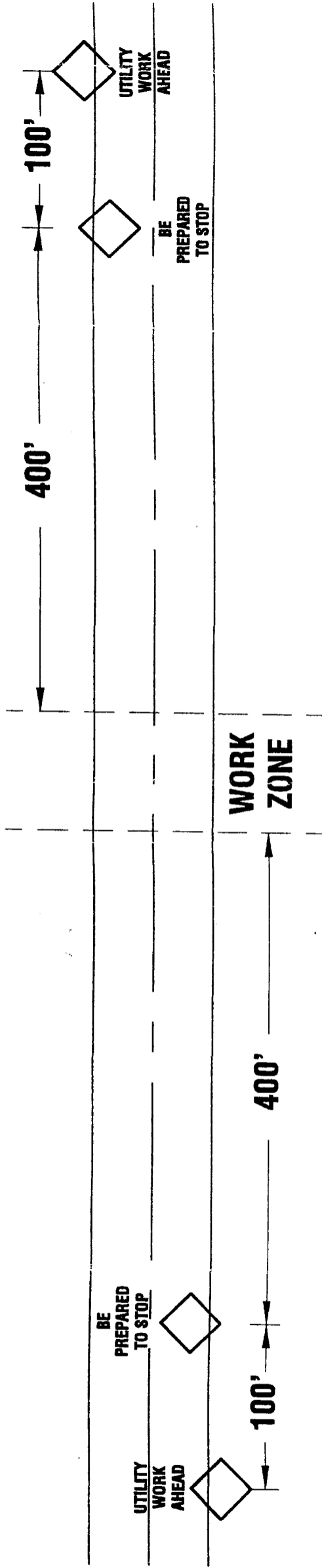

IF WORK ZONE IS NOT ON TRAVELED SURFACE: FIRST SIGN IS ALL THAT IS NEEDED. SIGN WILL READ "UTILITY WORK AHEAD" OR "SHOULDER WORK AHEAD".

IF WORK ZONE IS ON TRAVELED SURFACE: FIRST SIGN WILL READ "UTILITY WORK AHEAD". SECOND SIGN WILL READ "BE PREPARED TO STOP".

IF ROAD IS TO BE CLOSED: YOU WILL GO TO NEAREST INTERSECTION ON EITHER SIDE OF WORK ZONE AND PLACE "ROAD CLOSED" SIGN. ALSO, SIGN WORK PLACE AS SHOWN ABOVE.

BY ORDER OF GOSHEN COUNTY ROAD AND BRIDGE SUPERINTENDENT
MUST COMPLY WITH PART VI OF THE MANUAL ON UNIFORM TRAFFIC
CONTROL DEVICES (MUTCD)